



Mobile NoteTaker

Quick Start Guide

Version 1.0

NexConcepts

www.NexConcepts.com

© 2004 SYNEX Corporation. All rights reserved. NexConcepts is a trademark of SYNEX Corporation or its subsidiaries and should be treated as such. All other product and company names may be trademarks of their respective owners.

Printed in USA. Part Number: MOBILENTQSG-FEN1

About This Guide	3
System Requirements	3
Installing Digital Pen Batteries	5
Installing the Ink Refill	5
Installing Mobile NoteTaker PC Software	6
Mobile NoteTaker Modes of Operation	7
Using Mobile NoteTaker	7
Connected Mode	9
Adding Ink to Microsoft Office with Annotator.....	11
Learning More	13
Ordering Supplies	13
Mobile NoteTaker Supplies	14
Keypad Shortcuts in Capture Mode	15

Thank you for your purchase of Mobile NoteTaker – the only product that captures your handwritten notes, drawings or sketches on ordinary paper without needing a PC, Notebook or PDA. After you capture your notes, synchronize Mobile NoteTaker with your PC/Notebook to edit, convert or share your notes.

About This Guide

This Mobile NoteTaker Quick Start Guide is for first-time users as well as users upgrading from earlier versions of the NoteTaker products. Before you begin using Mobile NoteTaker, be sure to read this guide for installation instructions and other important information. For more detailed information, please refer to the User Guide (located on the installation CD) or the online help file (located within the software application).

System Requirements

- Microsoft Windows 2000 (SP4) or XP (SP1)
- Minimum 30MB available hard disk space
- Minimum 64MB RAM; 128MB Recommended
- Minimum 16 bit color quality; 32 bit Recommended
- Minimum Screen resolution of 800x600 pixels
- Available USB port; Microsoft Internet Explorer 6.0
- For Annotator: Microsoft Office 2000 (SP3), XP (SP3) or 2003
- For Pen2Text: Microsoft Office XP (SP3) or 2003 with handwriting recognition engine installed
- For ICQ Support: ICQ Pro 2003 or higher

Installing Mobile NoteTaker Batteries

Remove battery compartment cover.



Install two AAA batteries; note the polarity direction as shown on the label. Replace battery compartment cover.

NOTE: Do not plug in your Mobile NoteTaker until the software installer prompts you.

After installing the batteries, press the **On/Off** switch and hold it for about three seconds. If this is the first time using Mobile NoteTaker, the **Time & Date** setup screen will appear. Use the **right** and **left** keypad buttons to select hour, minutes, month, day and year. Use the **up** and **down** keypad buttons to change the blinking selection.



Installing Digital Pen Batteries



Remove the battery cover. Install three SR41 batteries, with the positive polarity facing up. Replace battery cover.



Installing the Ink Refill

Slide the new refill into the tip of the pen. Gently press it in until it is securely in place.



<p>To remove the Ink Refill: Remove Pen cap. The external edge of the pen cap is a refill extractor. Insert the tip of the pen into the refill extractor. Pull out the refill. The refill is now removed from the pen.</p>	<p>WARNING: Do not attempt to open the Digital Pen. This may cause the pen to malfunction. Only open the top to install/replace batteries.</p>
<p>Refill Extractor</p> 	

Installing Mobile NoteTaker PC Software

1. Insert the **NoteTaker** software CD into your CD ROM drive. The application setup program will run automatically.
2. Follow the instructions on the screen.
3. Once software installation is complete, two consecutive driver installations will begin automatically during which you will be prompted to plug in your Mobile NoteTaker.

NOTE: Do not plug in Mobile NoteTaker until the software installer prompts you.

4. **NoteTaker** icon automatically appears on the desktop.
5. Double-click the **NoteTaker** icon to run the program.

NOTE:

If Setup does not start automatically, run the program from the Windows **Start** menu. Click **Start**, and then select **Run**. In the **Open** box, type **D:\setup.exe**. If your CD drive uses a different drive letter, type that letter instead of D. You can also setup the software by opening the CD drive folder and double-clicking the **setup.exe** file.

Mobile NoteTaker Modes of Operation

Your Mobile NoteTaker can operate in two modes:

- **Mobile Mode** – Use Mobile NoteTaker to capture and save notes anywhere.
- **Connected Mode** – Use Mobile NoteTaker when connected to a PC to:
 - Upload saved Notes
 - Capture notes or drawings, annotate documents or files, print and share notes.

Using Mobile NoteTaker

Attach Mobile NoteTaker on a single sheet of paper or a pad of paper up to letter sized (8.5" x 11"); either single sheets of paper or pads of paper up to 1/2" thick. Taking notes with Mobile NoteTaker is very easy. Just turn on the unit and start writing with the digital pen! As you write you'll notice that the LCD will display what you are writing. The LCD automatically scrolls as you write.

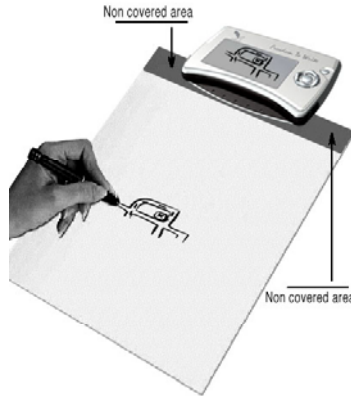

- **Save Note** – Using your pen, press virtual button 5 or the right keypad button twice.
- **Advance to next page** – Press virtual button 4 or the right keypad button once.
- **Scroll Screen** – Press the OK button (on the center of the keypad) then use the keypad buttons to navigate around your saved documents. To exit out of Scroll Screen mode, click the OK button again.
- **Zoom** – Press the top keypad button to zoom in; press bottom keypad button to zoom out.

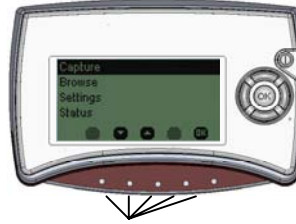

Virtual Buttons

Mobile NoteTaker has a straightforward operating system that can be navigated with the keypad buttons or using the virtual buttons.

- **Capture** – If you do not have Auto Capture On, then select Capture to begin saving notes/drawings.
- **Browse** – Review notes that you have saved in memory
- **Settings** – Turn on and off Auto Capture; Set Time and Date, Turn on and off Sound, Set Contrast, Set Auto Shutdown and Clear Memory
- **Status** – Battery and memory availability information and current date and time.
- **About** – Firmware information

Connected Mode

In Connected mode, you can upload or create notes with your Mobile NoteTaker.

To upload captured and saved notes

1. Connect the base unit to a PC with supplied *USB cable*
2. On the PC, run the NoteTaker program.
3. In the Notes Manager **File** menu, click **Upload** or press the Upload icon.
4. Your notes will appear in the **Upload** folder.



Note: If **Upload** is grayed out, then your drivers are not properly installed. Refer to the *Users Guide* located on the installation CD for more information.





To create a new note

A new note will automatically appear on your computer screen as soon as you start writing with your digital pen.

Note: You can also start the application by clicking the **Start** button, then **Program**, then **NexConcepts** folder and selecting the **NoteTaker** icon.

Saving & Working with your Notes

Once you have completed creating a note, you can:

1. **Save** - Click on the save note icon on the Toolbar. The note will automatically be saved in the miscellaneous folder. 
2. **Send by e-Mail** – Click on the Send by e-mail icon on the Toolbar. A new e-Mail will open with the Note as a JPEG attachment. Type in the desired recipient's e-Mail address and any desired text in the subject and body of the e-Mail. 
3. **Send by Instant Message** – Click on the Send by ICQ icon on the Toolbar. The note will automatically be sent as an attachment.
Note: ICQ Pro must be previously installed. (www.ICQ.com) A file can be sent to 'Online' users only. 
4. **Send by Network** – Click on the Send by Network icon on the Toolbar. Select the Name/IP address of the person to whom you would like to send the Note (a list of all network users that have the NoteTaker application installed and running will automatically appear). Press Send. 

5. **Export to JPEG** – Click on the Export to JPEG icon on the Toolbar to save the note in JPEG for use in other applications. Choose the destination file path then select the resolution quality and click Save. 

6. **Copy to Clipboard** – Click on the Copy icon on the Toolbar. This will copy the selected Note and save it to the clipboard for use in other applications. 

Adding Ink to Microsoft Office with Annotator

Use Annotator to add ink to any Microsoft Office application (Word, Outlook, Excel or PowerPoint). After installing Annotator, depending on the application you are using, you will see a toolbar with three or four buttons.

The first button is to activate the Annotator. Click on **Ink On** to start an ink session, and a floating panel will pop up and become available for you to adjust ink settings.

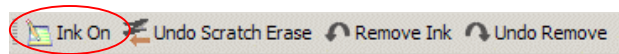

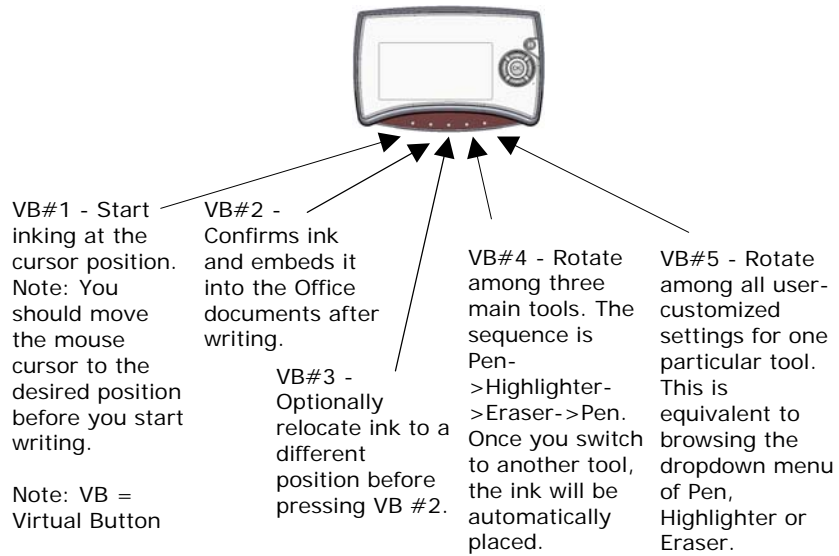
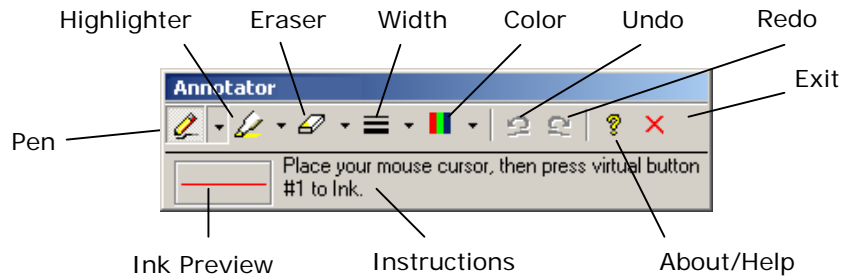

Learning More

- The *User Guide* and online help provide a comprehensive reference for Mobile NoteTaker. The *User Guide* is located on the installation CD. The online help is located within the software application.
- Visit us on the Web at www.NexConcepts.com.
- NexConcepts Technical Support can be reached at:
 - United States and Canada: (888) 59NOTES (596-6837).
 - Support@NexConcepts.com.

Ordering Supplies

To purchase replacement supplies, visit your nearest office supply store or order directly from NexConcepts.

- NexConcepts Sales Support can be reached at:
 - United States and Canada: (888) 95NOTES (956-6837)
 - info@NexConcepts.com

Mobile NoteTaker Supplies

- Digital Pen Part Number: MOBILENT-PEN-N1

Any of the following refills fit the Mobile NoteTaker Digital Pen:

Staedtler Ink Refills

930-2 Red Fine Point
930-3 Blue Fine Point
930-9 Black Fine Point
930 ASBK3 Assortment

Yafa Ink Refills

97099 Black Fine Point
97100 Blue Fine Point
97102 Red Fine Point
97110 Green Fine Point

Mobile NoteTaker Digital Pen uses the following batteries:

Duracell	D392	Sony	SR41W
Energizer	392	Timex	K
Maxell	SR41W	Toshiba	SR41W
Panasonic	SP392	Varta	V392

Keypad Shortcuts in Capture Mode

Navigation Mode - Press OK then use any one of the four keypad buttons to navigate around the Mobile NoteTaker screen – Press OK again to exit out of navigation mode.

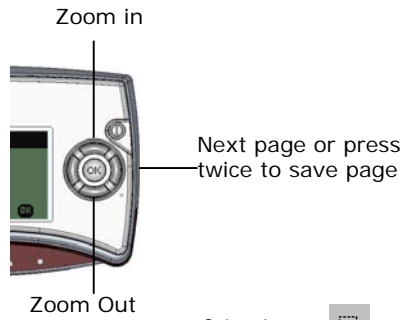

Letter View		Memo View		Select Area	
Edit Note		Clear		Pen	
Undo		Redo		Highlighter	
Note Color		Pen Styles		Line	
Copy		Print		Circle	
Send by Network		Send by ICQ		Rectangle	
Send by e-Mail		Export to JPEG		Text	
Save to		Save		Pen/Highlight	
Close Note				Width 1	
				Width 2	
				Width 4	
				Width 8	